



ASISAFE BASIC SAFETY MONITOR 2 F-RO, 2 ENABLING CIRCUITS, IP20, WITH SCREW-TYPE TERMINALS (REMOVABLE), SAFE OUTPUT RELAY RESPONSE TIME MAX. 40 MS, MONITOR TYPE 2, VERSION 3, APPLICABLE UP TO CATEGORY 4 (EN 954-1), UP TO PL E (EN ISO 13849-1), UP TO SIL 3 (IEC 61508), FOR AS-INTERFACE / AS-I SAFETY AT WORK

General technical data:

<b>Design of the product</b>		safety monitor
<b>Protocol is supported AS-interface protocol</b>		Yes
<b>Type</b>		2 enabling circuits
<b>Number of release circuits</b>		2
<b>Response time max.</b>	ms	40
<b>Type of electrical connection of the inputs and outputs</b>		screw terminal
<b>Rated operational current Ie</b>		
• AC-12, 50/60 Hz 250 V	A	3
• AC-15, 50/60 Hz		
— 115 V	A	3
— 230 V	A	3
• DC-12 (DC-1) 24 V	A	3
• DC-13 (DC-11)		
— 24 V	A	1
— 115 V	A	0.1
— 230 V	A	0.05

Equipment marking acc. to DIN 40719 extended according to IEC 204-2 acc. to IEC 750		A
Equipment marking acc. to DIN EN 61346-2		F

#### Ambient conditions:

<b>Ambient temperature</b>		
• during operation	°C	-20 ... +60
• during storage	°C	-30 ... +70
<b>Protection class IP</b>		IP20

#### Mechanical data:

<b>Width</b>	mm	45
<b>Height</b>	mm	108
<b>Depth</b>	mm	120
<b>Mounting type</b>		screws / standard rail

#### Certificates/ approvals:

<b>General Product Approval</b>	<b>Functional Safety/Safety of Machinery</b>	<b>Declaration of Conformity</b>	<b>Shipping Approval</b>
---------------------------------	--	----------------------------------	--------------------------



[Type Examination Certificate](#)



<b>Shipping Approval</b>	<b>other</b>
--------------------------	--------------



[Environmental Confirmations](#)

<b>other</b>
--------------

[Confirmation](#)

#### Further information

**Information- and Downloadcenter (Catalogs, Brochures,...)**

<http://www.siemens.com/industrial-controls/catalogs>

**Industry Mall (Online ordering system)**

<http://www.siemens.com/industrymall>

**Cax online generator**

<http://support.automation.siemens.com/WW/CAXorder/default.aspx?lang=en&mlfb=3RK1105-1BE04-0CA0>

**Service&Support (Manuals, Certificates, Characteristics, FAQs,...)**

<https://support.industry.siemens.com/cs/ww/en/ps/3RK1105-1BE04-0CA0>

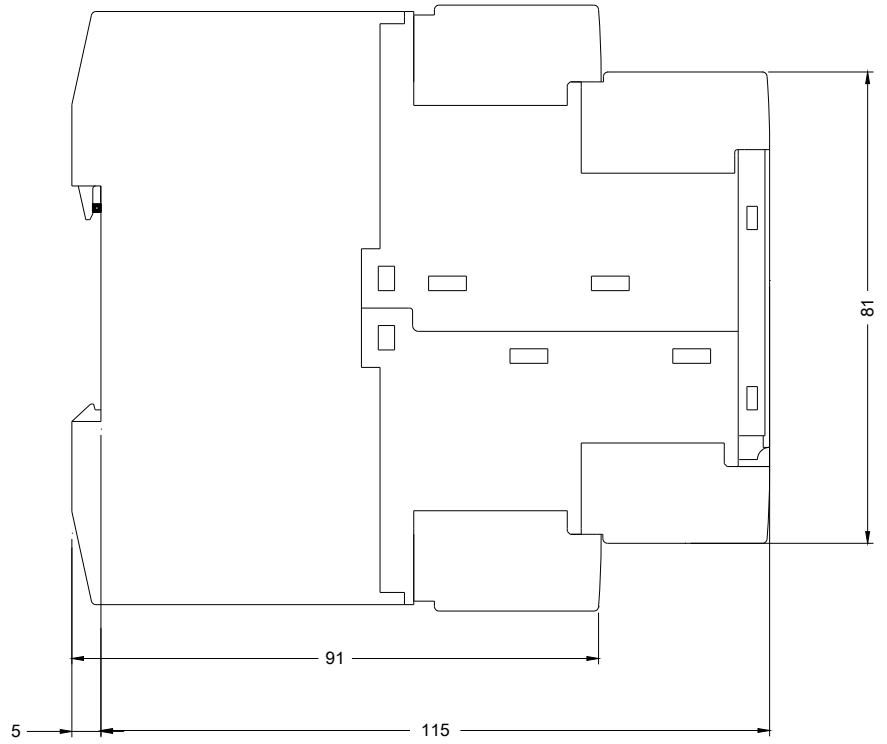
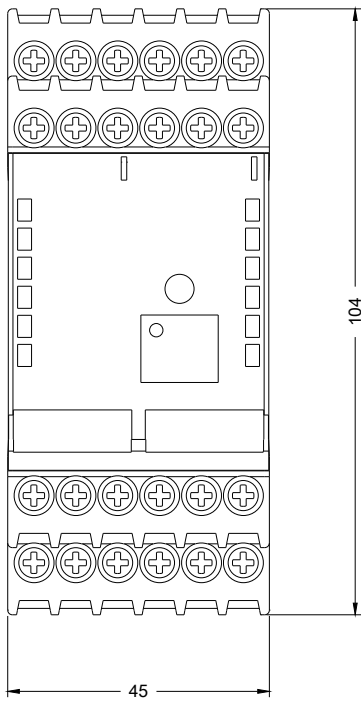

last modified:

07/17/2017